

SwiftLock® QR Scope Rings

30mm scope ring mounts for Picatinny rail systems.

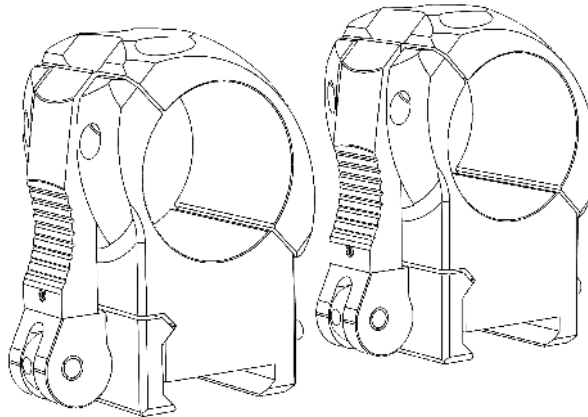

SwiftLock® QR scope rings are designed for secure, repeatable installation of 30mm optics on Picatinny-type rails. This manual covers safe handling, mounting, locking adjustment, maintenance and warranty information.

Safety advice. Always confirm that the firearm is unloaded before fitting, removing or adjusting the mounts. Remove the magazine, open the action and visually check the chamber. Keep the muzzle pointed in a safe direction and follow the firearm manufacturer's instructions at all times.

Specifications

Parameter/ Model	MSLR-3025P Low	MSLR-3030P Medium	MSLR-3034P High
Weight (set of two), g	230	264	284
Optical height*, mm	25	30	34
Material	416 Stainless steel & 7075-T6 aluminium	416 Stainless steel & 7075-T6 aluminium	416 Stainless steel & 7075-T6 aluminium

* Optical height is the distance from the top of the mounting rail to the centre line of the scope tube.

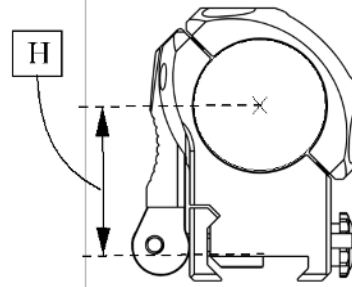
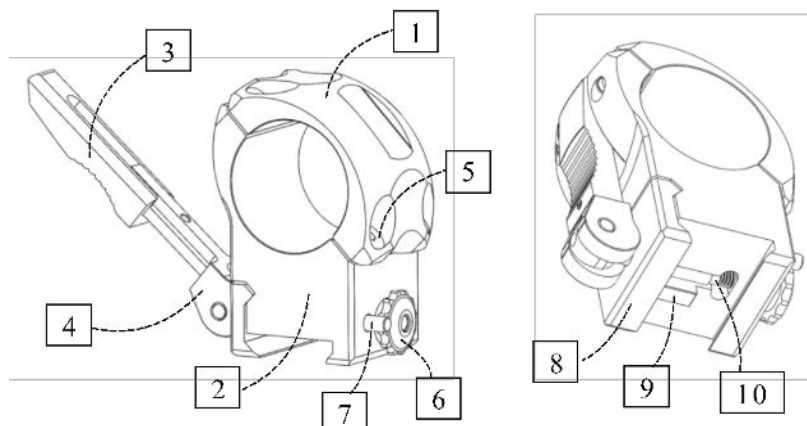

Fig.1

Product Elements

- 1 Upper ring half
- 2 Lower ring half
- 3 Telescopic handle
- 4 Locking lever
- 5 Torx screws (x4)
- 6 Locking nut
- 7 Indexing pin
- 8 Side locking plate
- 9 Recoil lug
- 10 Tightening screw



Setting up and adjustment

SwiftLock® QR Scope Rings offer an ergonomic and reliable locking mechanism. The telescopic action adds leverage for easier, stronger locking, while the vertical orientation provides unobtrusive access, even when wearing gloves.

Please operate the locking mechanism as follows (Fig. 3):

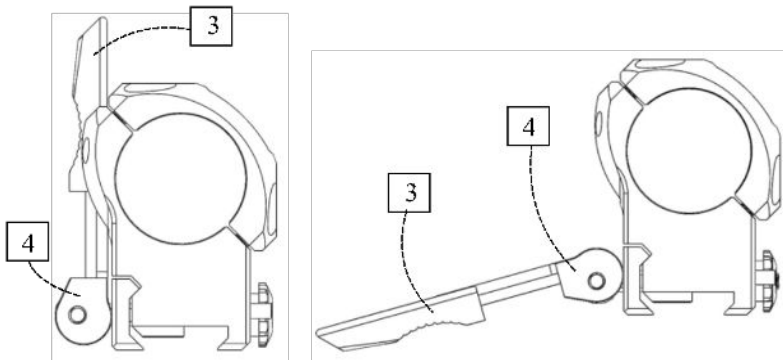

Fig.3

- Lift the telescopic handle 3 to extend it fully before operating the locking lever 4. (View A)
- With the handle 3 extended, push it away from the mount body. (View B)

The locking force adjustment procedure

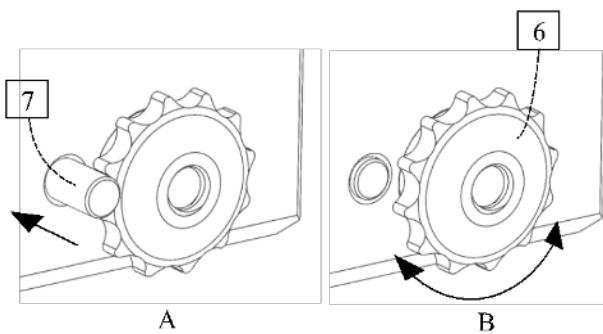

Fig.4

- Only adjust the locking force with the locking lever open and the telescopic handle extended (Fig. 3B).

- Press indexing pin 7 inward (Fig. 4, View A) to release locking nut 6, then rotate it clockwise to increase locking force or anticlockwise to reduce it (Fig. 4, View B).
- Make small adjustments and check the fit on the rail after each step. The mount should lock positively without excessive force.
- After the desired locking force is achieved, make sure the locking pin is fully extended and sits between the notches of the locking nut.
- Make sure the locking force is set so that both rings clamp with similar resistance.

Mounting the scope

After installing the mounts on the rail in the desired position, proceed with mounting the scope in the rings.

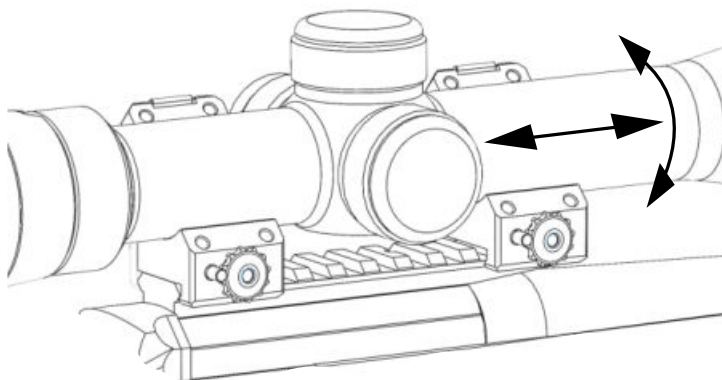

Fig. 5

- Unscrew and remove the upper ring halves.
- Place the scope into the recesses of the mounts.
- Move the scope backwards or forwards to achieve a comfortable head position and optimal eye relief, then rotate it to align the reticle horizontally and vertically (Fig. 5).

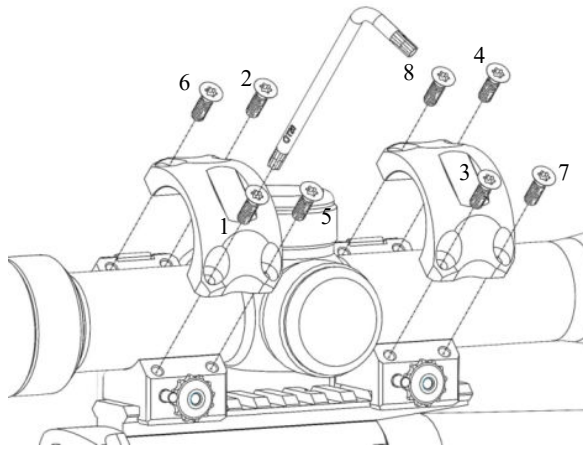

Fig. 6

- Tighten the upper ring screws gradually in a cross pattern (1-2-3-4-5-6-7-8) over several passes (Fig.6)
- Recommended ring-cap torque: 2-3 Nm (18-27 in-lbs).
- While gradually tightening the screws, keep the left and right gaps (12 and 13) equal on both rings (Fig. 7).

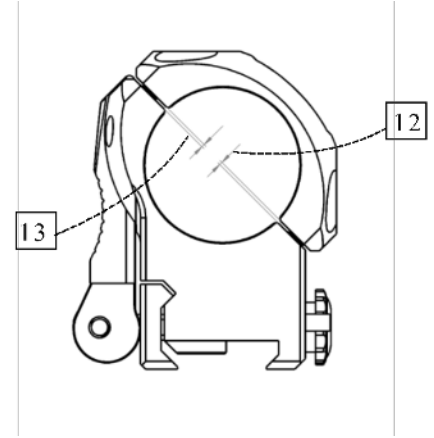

Fig. 7

Final check. After installation, confirm that the scope is secure, the reticle is level, eye relief is correct, and both locking levers are fully closed. Re-check screw torque after the first range session.

MAINTENANCE AND WARRANTY

Maintenance advice

- Keep rail-contact surfaces, locking components and screw heads free from dirt, oil and abrasive debris.
- Wipe exposed metal parts with a lightly oiled cloth after use in wet conditions, then dry before storage.
- Inspect the locking lever, locking nut and screws regularly for damage, loosening or unusual wear.
- Do not use thread-locking compounds or lubricants unless approved for your installation procedure.
- Store the product clean and dry. If removed from the firearm, protect clamping surfaces from knocks and corrosion.

Warranty

- SwiftLock® QR mounts are covered by a warranty against defects in materials and workmanship from the date of purchase.
- The warranty does not cover damage caused by misuse, improper installation, unauthorised modification, impact damage, corrosion from poor storage, or normal cosmetic wear.
- To support a warranty claim, retain proof of purchase and provide product details together with a clear description of the fault.

Support: For product support or warranty enquiries, contact Immersive Optics with the product description, purchase details and photographs of the issue where possible.

Immersive Optics Limited
Unit D, Cloberfield Business Centre
15 Cloberfield, Glasgow
G62 7LN, United Kingdom

www.immersive-optics.com